

# SOLAR POWER LOCATION AND CONSTRUCTION PERMIT

## CARROLL COUNTY PLANNING & ZONING

114 East 6<sup>th</sup> St., Carroll, Iowa 51401

Phone (712) 792-9532 FAX (712) 792-9537

Type of Application: Residential: \_\_\_\_\_ Solar Garden: \_\_\_\_\_ Utility Scale: \_\_\_\_\_

Phone Number (\_\_\_\_) \_\_\_\_ - \_\_\_\_\_

Applicant Name: \_\_\_\_\_

Address: \_\_\_\_\_ City: \_\_\_\_\_ State: \_\_\_\_\_ Zip: \_\_\_\_\_

Contractor Name: \_\_\_\_\_

City: \_\_\_\_\_ State: \_\_\_\_\_ Zip: \_\_\_\_\_ Phone Number (\_\_\_\_) \_\_\_\_ - \_\_\_\_\_

Location (Legal Description) \_\_\_\_\_ Parcel ID# \_\_\_\_\_

**PLEASE SUBMIT A MAP SHOWING THE STRUCTURE'S LOCATION ON THE PROPOSED CONSTRUCTION SITE**

Is the proposed solar power array located in any of the following?

- An "Agricultural Area" consisting of over 300 acres and approved by the County Board of Supervisors per Iowa Code 352.6
- Within 2 Miles of Carroll or Glidden City Limits
- In an Unincorporated Community, Such as Mt. Carmel, Maple River or Roselle
- Flood Plain
- Within the Airport Airspace Overlay (see attached map)

Zoning District Designation for proposed Solar Power Array: \_\_\_\_\_

Type of Array: Building Mounted: \_\_\_\_\_ Roof Mounted: \_\_\_\_\_ Ground Mounted: \_\_\_\_\_

Solar Easement with adjoining property owners needed? Yes: \_\_\_\_\_ No: \_\_\_\_\_ (If yes, provide a copy of the agreement)

### Solar Garden or Utility Scale Arrays only:

Indicate if the following information is attached to the Application (Criteria contained in Section 14.15.070 Carroll County Zoning Ordinance):

Site Plan			
Number, Location & Spacing of Panels/Arrays	<input type="radio"/> Yes	<input type="radio"/> No	<input type="radio"/> Not Applicable <u>Ref: 14.15.070.02.3.A</u>
Planned Location of Underground or Overhead Lines	<input type="radio"/> Yes	<input type="radio"/> No	<input type="radio"/> Not Applicable <u>Ref: 14.15.070.02.3.B</u>
Project Development Timeline	<input type="radio"/> Yes	<input type="radio"/> No	<input type="radio"/> Not Applicable <u>Ref: 14.15.070.02.3.C</u>
Interconnection Agreement	<input type="radio"/> Yes	<input type="radio"/> No	<input type="radio"/> Not Applicable <u>Ref: 14.15.070.02.3.D</u>
Decommissioning Plan	<input type="radio"/> Yes	<input type="radio"/> No	<input type="radio"/> Not Applicable <u>Ref: 14.15.070.02.5</u>
Grading Plan	<input type="radio"/> Yes	<input type="radio"/> No	<input type="radio"/> Not Applicable <u>Ref: 14.15.070.02.4.D</u>
Aviation Protection	<input type="radio"/> Yes	<input type="radio"/> No	<input type="radio"/> Not Applicable <u>Ref: 14.15.070.02.4.F</u>
Signage	<input type="radio"/> Yes	<input type="radio"/> No	<input type="radio"/> Not Applicable <u>Ref: 14.15.070.02.4.J</u>
Fencing	<input type="radio"/> Yes	<input type="radio"/> No	<input type="radio"/> Not Applicable <u>Ref: 14.15.070.02.4.K</u>

Construction Start Date \_\_\_\_/\_\_\_\_/\_\_\_\_ Estimated Completion Date \_\_\_\_/\_\_\_\_/\_\_\_\_

**I certify under penalty of perjury and pursuant to the laws of the state of Iowa that this application is true and correct.**

Signature of Applicant: \_\_\_\_\_ Date: \_\_\_\_\_

Approved       Disapproved

Date \_\_\_\_\_

Signature \_\_\_\_\_

Permit Number \_\_\_\_\_ Fee: \_\_\_\_\_

Reason for Denial (if necessary) \_\_\_\_\_

\_\_\_\_\_

\_\_\_\_\_

\_\_\_\_\_

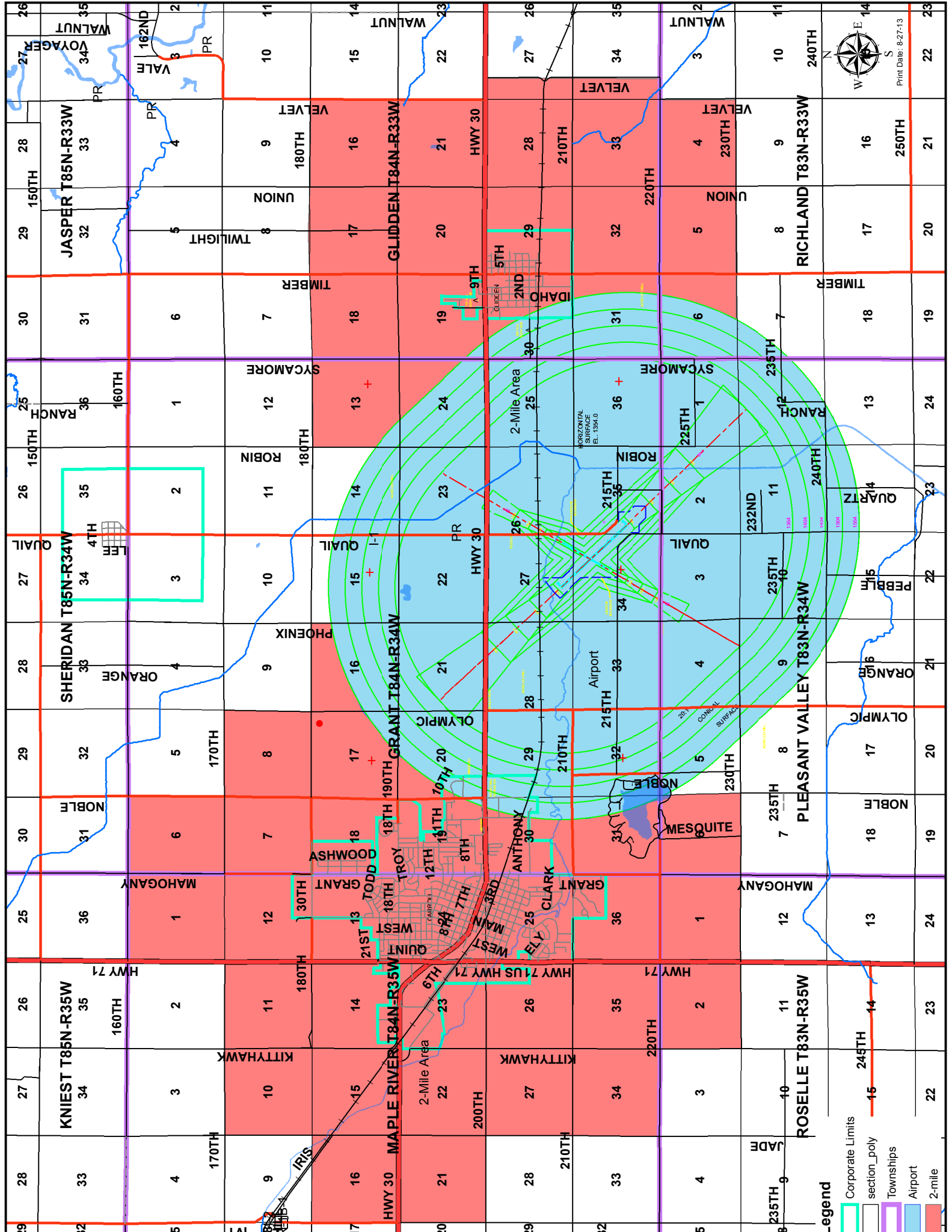

- Legend**
- Corporate Limits
  - section\_poly
  - Townships
  - Airport
  - 2-mile



Print Date: 8-27-13